

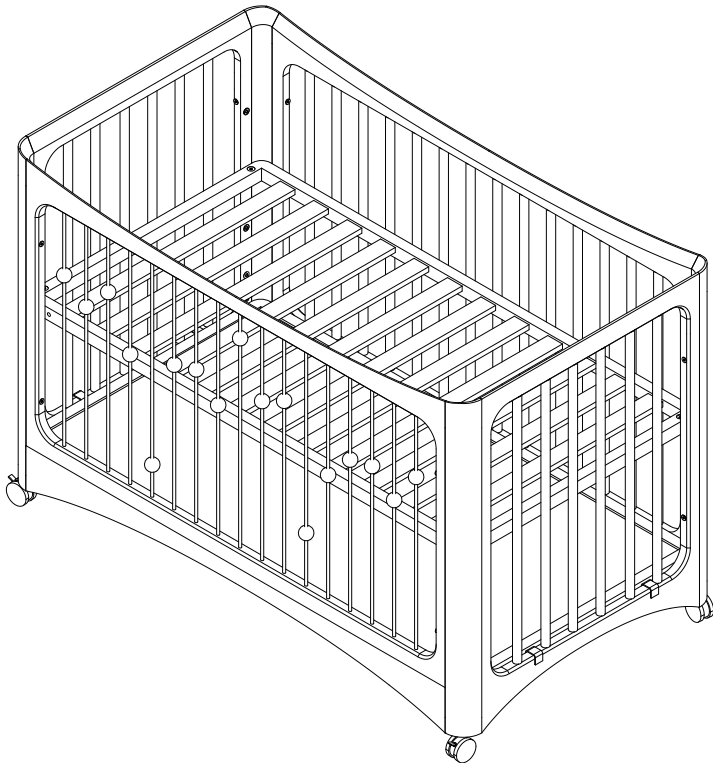

# 101 WOODEN CRIB MANUAL



## Important Notice:

To ensure the cleanliness of the bed, a soft dry cloth can be used to wipe it. Please do not use wet cloths, abrasives, or bleaching on the surface of the product. Wipe with powder, alcohol or other chemical solvents.

**Be careful! Only adults are allowed to install, children are not allowed to approach.**

## Product Introduction:

Product name: wooden crib

Product color: multicolor

Product model: 101

Main material: Beech wood

Product size: L1245 X W 695 XH 845 MM

5.Applicable age: 3 years old

### Usage environment:

Please use in a dry and ventilated indoor space, avoiding direct sunlight to prevent fading, cracking, and deformation of the product's paint surface and components; Do not use near fire sources or other strong heat sources (such as electric heaters, gas heaters, radiators, etc.) to avoid danger.

### Performance features:

Performance features: This baby crib has an elegant and simple design, and is safe to use. Six level height adjustment of the bed board to adapt to different growth stages of infants; It can be integrated with adult beds to facilitate parental care and cultivate independent sleeping abilities in infants and children; The product has diverse functions, such as a variable easel and study desk, to accompany the growth of infants and children.

## Tips

1. Please carefully read the product manual and follow the steps for installation. During installation, do not place the product on uneven or rough surfaces;
2. This product is suitable for age range: 0-3 years old;
3. When using this product, the caregiver must not leave to avoid danger;
4. Please do not leave unrelated items in the child's bed to avoid danger;
- 5.This product is flammable and should not be used near sources of fire or other strong heat sources (such as electric heaters, gas heaters, radiators, etc.) to avoid danger;
6. When the bed board is too damp due to natural or human factors, please place it in a cool and ventilated place to dry naturally. Do not expose it to sunlight to avoid deformation or cracking of the bed board;
7. This product needs to be used with a mattress. It is recommended that the mattress size be 1200X650MM and the thickness be less than 100MM;
8. When starting to install this product, please check if all parts are intact and undamaged. If any parts are damaged or lost, do not use;
9. After the product assembly is completed, it is necessary to confirm that the installation positions of each component are accurate and all screws and bolts are tightened without looseness before using this product;

## Tips

10. Attention! Only adults are allowed to install, children are not allowed to approach. After the product installation is completed, please clean the plastic bags and other packaging materials in a timely manner. They cannot be used as toys for infants and children to prevent accidents;

11. Please keep this manual and the tools used for installation properly for future use.

## Warning and safety precautions

- Warning: Failure to follow these warning statements and instructions may result in serious injury!
- Warning: Do not leave anything in the crib that may serve as a stepping point or cause suffocation or strangulation.
- Warning: This product should not be used near fire sources or other strong heat sources (such as electric heaters, gas heaters, etc.) to avoid overheating Posing a danger;
- Warning: If any part of the fence or similar use crib is damaged, torn, or lost, the fence or similar use crib must not be used;
- Warning: When children start standing on their hands or knees, if the toy is not removed, entanglement or strangulation injuries may occur;
- Warning: Do not leave children unattended while they are playing in fences or similar child beds.
- Please carefully read the user manual and follow the steps for installation. During installation, do not place the product on uneven or rough surfaces;
- This product is suitable for ages 0-3 years old, with a maximum height of 110CM and a weight of 35KGS;
- The maximum load-bearing capacity of this product's pavement is 35KGS, and it should not be used overweight. The maximum load-bearing capacity refers to the static load, that is, when infants or children lie down or the load capacity of the bed surface when sitting down;
- When using this product, the caregiver must not leave to avoid danger, and it is prohibited to leave the baby unattended in the crib;
- In any case, when placing a baby in a crib, it is important to ensure that the four side guardrails and bed bottom locking mechanism are in a safe position Locked state;
- Please be aware of the danger of leaving items in the bed. Do not leave unrelated items in the crib to avoid danger;
- Do not place medication, ropes, rubber bands, small toys, or items (such as coins) around the crib that are within reach the place;

## Warning and safety precautions

- The crib surface has six adjustable heights, and placing the bed board in the lowest position is always the safest option. When the baby is old enough to sit up or stand up, the bed board of the crib must be fixed in the lowest position for use;
- When the bed board is too damp due to natural or human factors, please place it in a cool and ventilated place for natural drying. Do not expose it to direct sunlight to avoid Bed board deformation or cracking;
- This product needs to be used with a mattress. Do not use more than one mattress in the crib; Ensure that when the bed board is in the lowest position, the height from the surface of the mattress to the upper edge of the bed fence is not less than 500mm; When the bed board is in the highest position The height from the surface of the mattress to the upper edge of the bed fence should not be less than 200mm; Overly thick bedding may pose a risk of infant and child rollover;
- Please use the matching mattress according to the instructions. Improper use of the mattress or use of a mattress not provided with this baby crib may cause suffocation Or the risk of falling;
- Infants and children must lie flat with their faces up, and there may be a risk of suffocation when lying prone or on their sides;
- To avoid injury and danger, the use of this product should be stopped when children can climb in and out of the crib
- Do not place the crib next to another product that may provide a stepping point or pose a risk of suffocation or strangulation, For example, ropes, blinds/curtain ropes, etc;
- Please make sure to place the baby crib on a level and stable surface. In any state, the bed surface must be level, otherwise it may Causing a risk of falling in infants and children;
- When using the crib, it is necessary to ensure that it is operated according to the instructions in this manual;
- It is prohibited to place infants and toddlers in the crib where the guardrail has not been raised to the highest position to avoid the risk of falling;
- Do not place the crib next to the adult bed. There must be a gap of at least 15 centimeters. When the crib is spliced with an adult bed, it is necessary to use safety straps to secure the crib according to the instructions to avoid the crib and The gaps between adult beds can cause harm to infants and children;
- When the baby bed is spliced with the adult bed, the surface of the adult bed mattress shall not be lower than the surface of the baby bed mattress;



## Warning and safety precautions

- If any part of the crib is damaged, torn, or lost, do not use the crib. Only spare parts approved by the manufacturer can be used.
- After the product is assembled, it is necessary to confirm that the positions of each component are accurate and that all components are securely fastened before using this product. During the use of the product, it is necessary to regularly check whether the components, screws, rivets, and washers are securely fastened, and whether the screws or connections are secure. Loosening may cause jamming of infants or clothing or other items (such as ropes, necklaces, etc.), posing a risk of strangulation;
- If the purchased baby crib has bed accessories, they must be installed according to the instructions. Improper installation may cause danger;
- When moving or adjusting the crib, the baby should not be left in the crib;
- Attention! Only adults are allowed to install, infants and children are not allowed to approach. The product installation is completed. Please handle the packaging materials such as strapping and plastic bags in a timely manner. Cannot be used as a toy for infants to avoid danger.
- Please keep this manual and the tools used for installation properly for future use.

## Tools required for construction

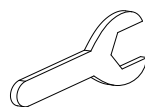
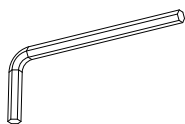

## Important information

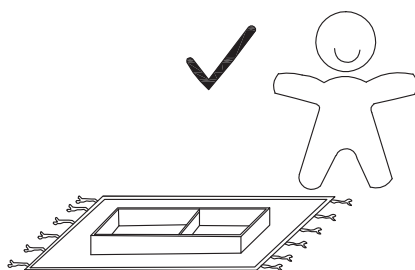
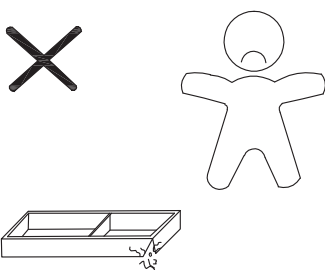
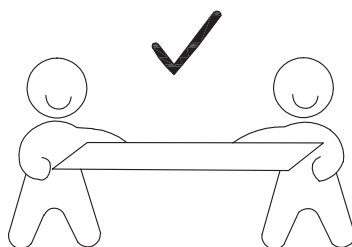
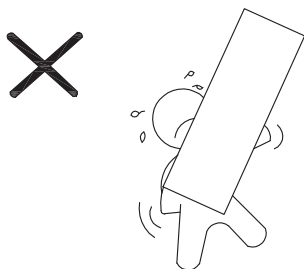
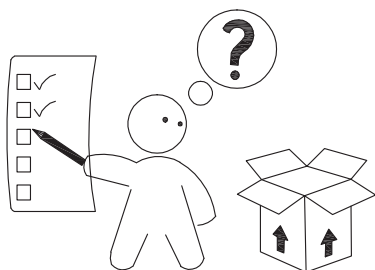

## Product components, names of raw and auxiliary materials, and usage locations

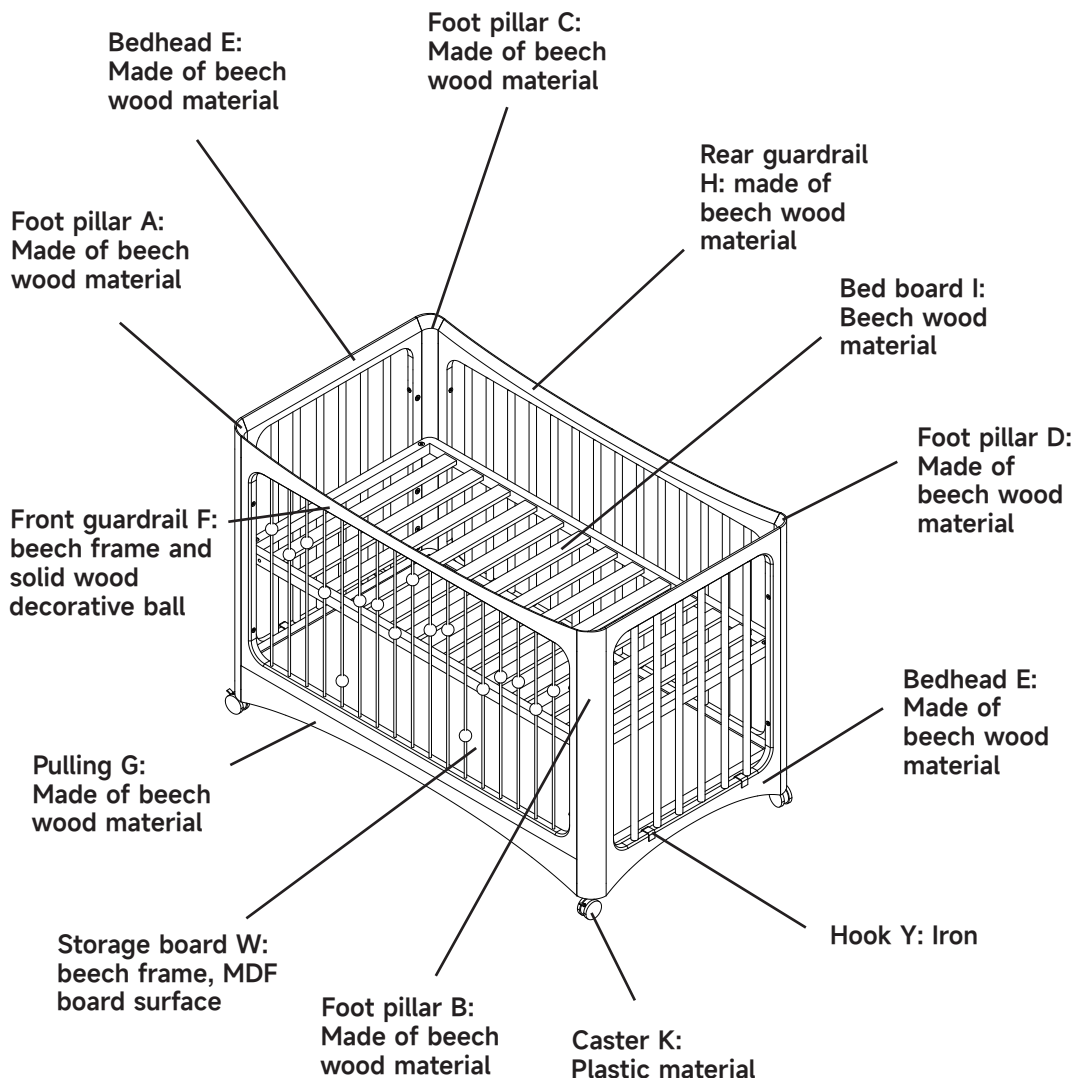

Note: The four foot pillars A/B/C/D are different, and during installation Please pay special attention to distinguishing!  
Suggested pairing: A 120X65CM mattress with a thickness not exceeding 10CM!

# Parts List



A  
Foot pillar  
(front left)



B  
Foot pillar  
(front right)



C  
Foot pillar  
(rear left)



D  
Foot pillar  
(rear right)

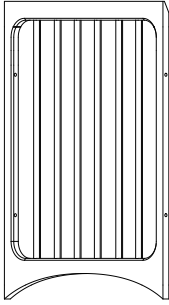

Bedhead E

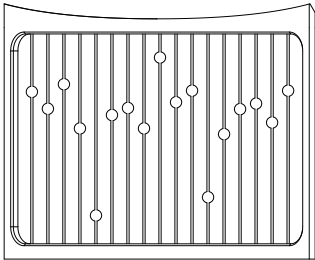
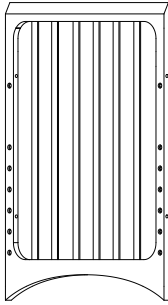

Front guardrail F

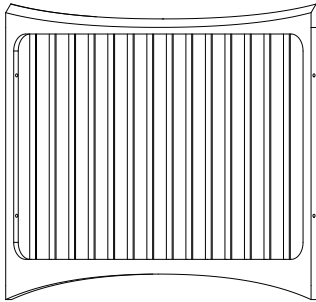

Pull gear: G

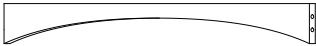

Rear guardrail H

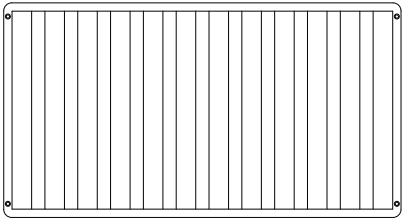

Bed board I

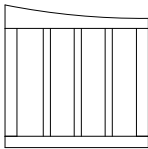

Small guardrail J

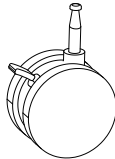

Caster K

Hardware parts and accessories:



L  
Screw

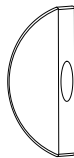

M  
Half circle  
blocking plate



N  
Nut



O  
Wood cutting

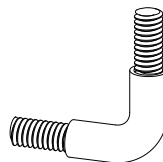

P  
L-shaped screw



Q  
Regarding  
the lock nut

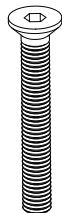

R  
Screw X4  
M6X45

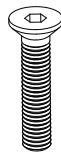

S  
Screw X2  
M6X35

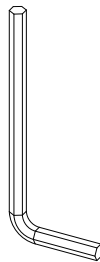

T  
Hexagon wrench

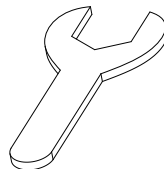

U  
Open wrench

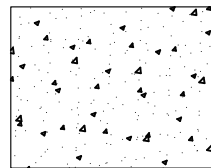

V  
Sandpaper  
  
(Unpainted areas with  
rough texture,It can be  
sanded with sandpaper)

Note: The classic model does not include the following components and hardware

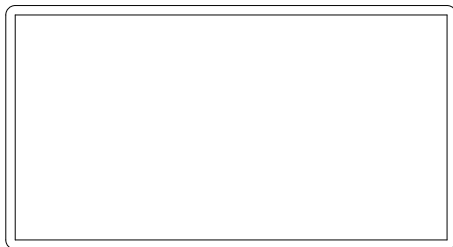

W  
Storage board

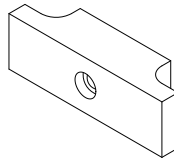

X  
Fixed clamp block

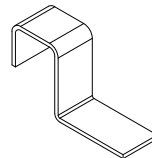

Y  
Hook

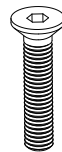

S  
Screw

## Assembly diagram:

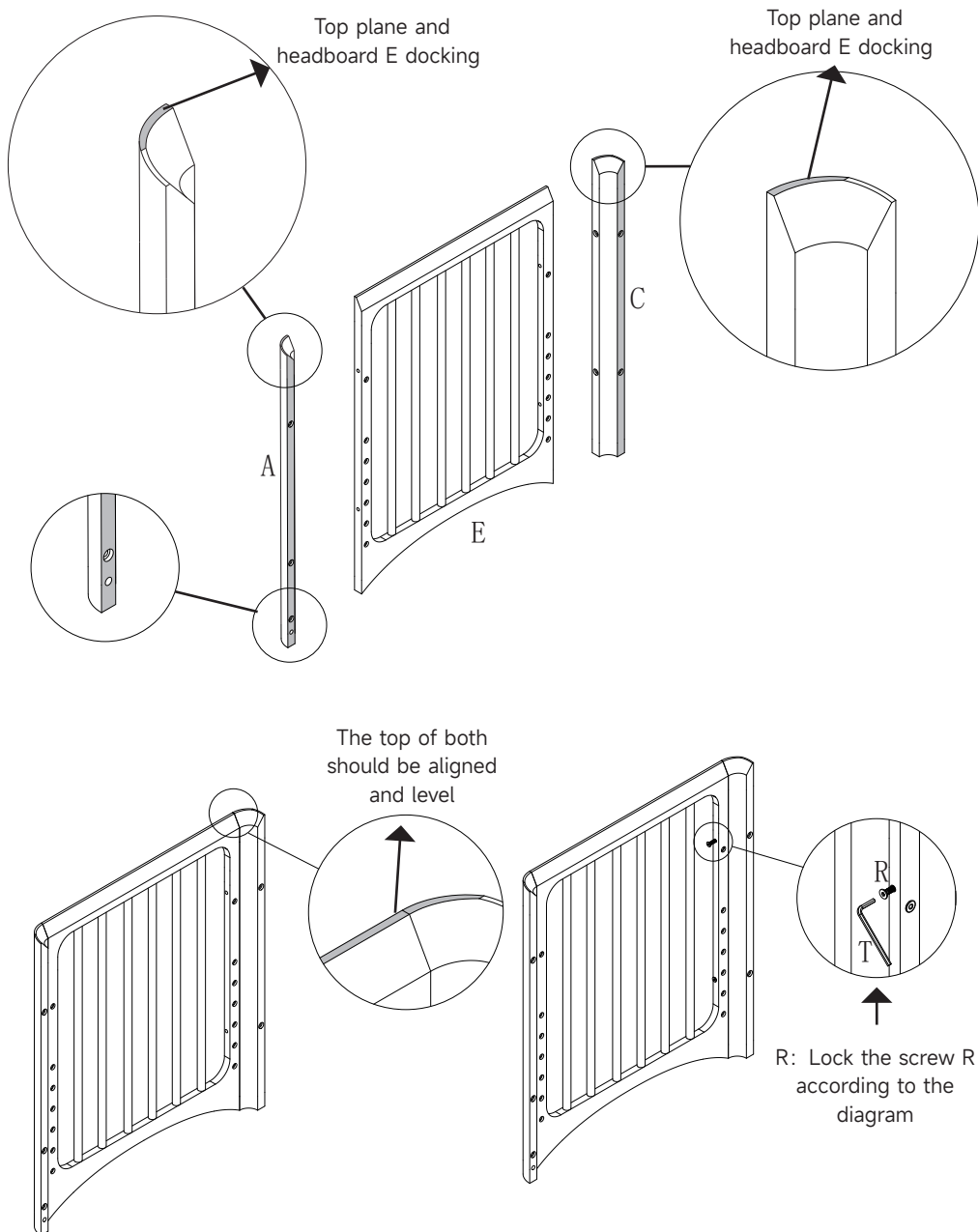

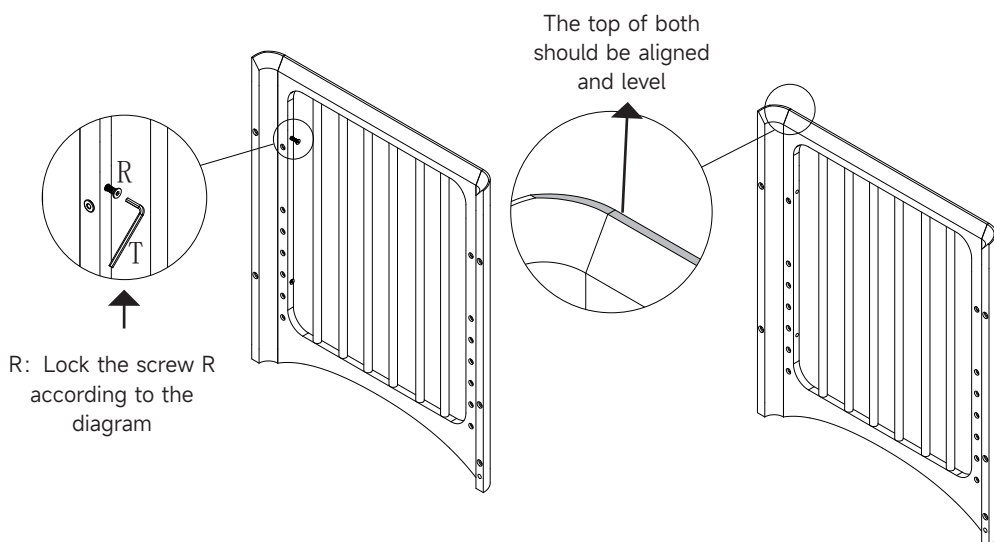
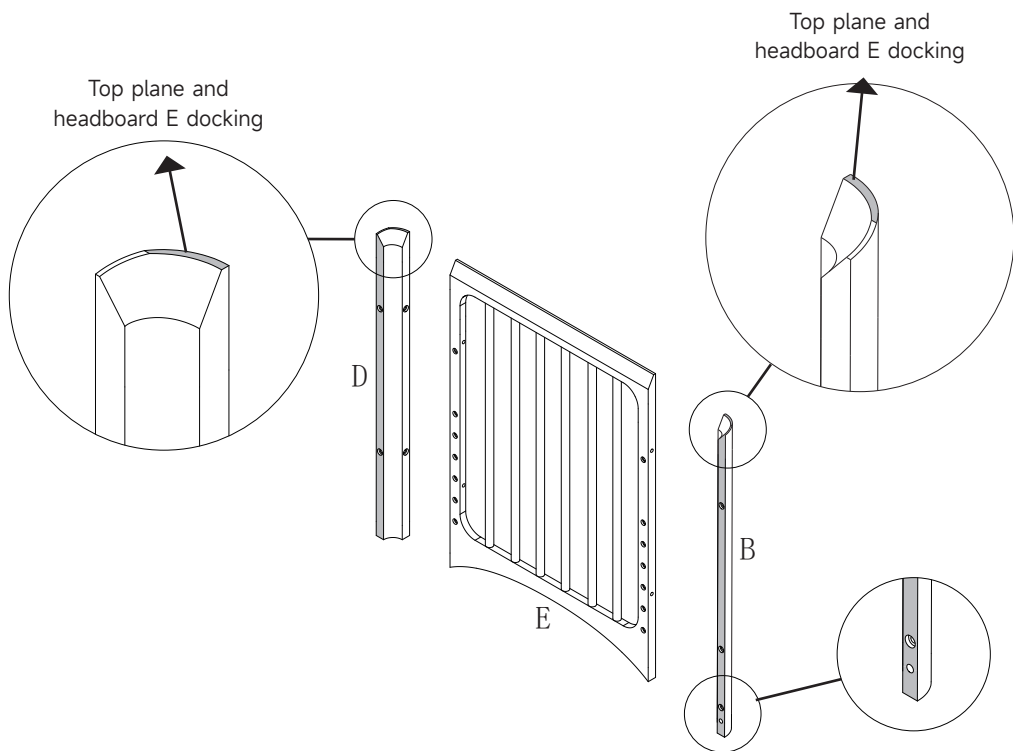

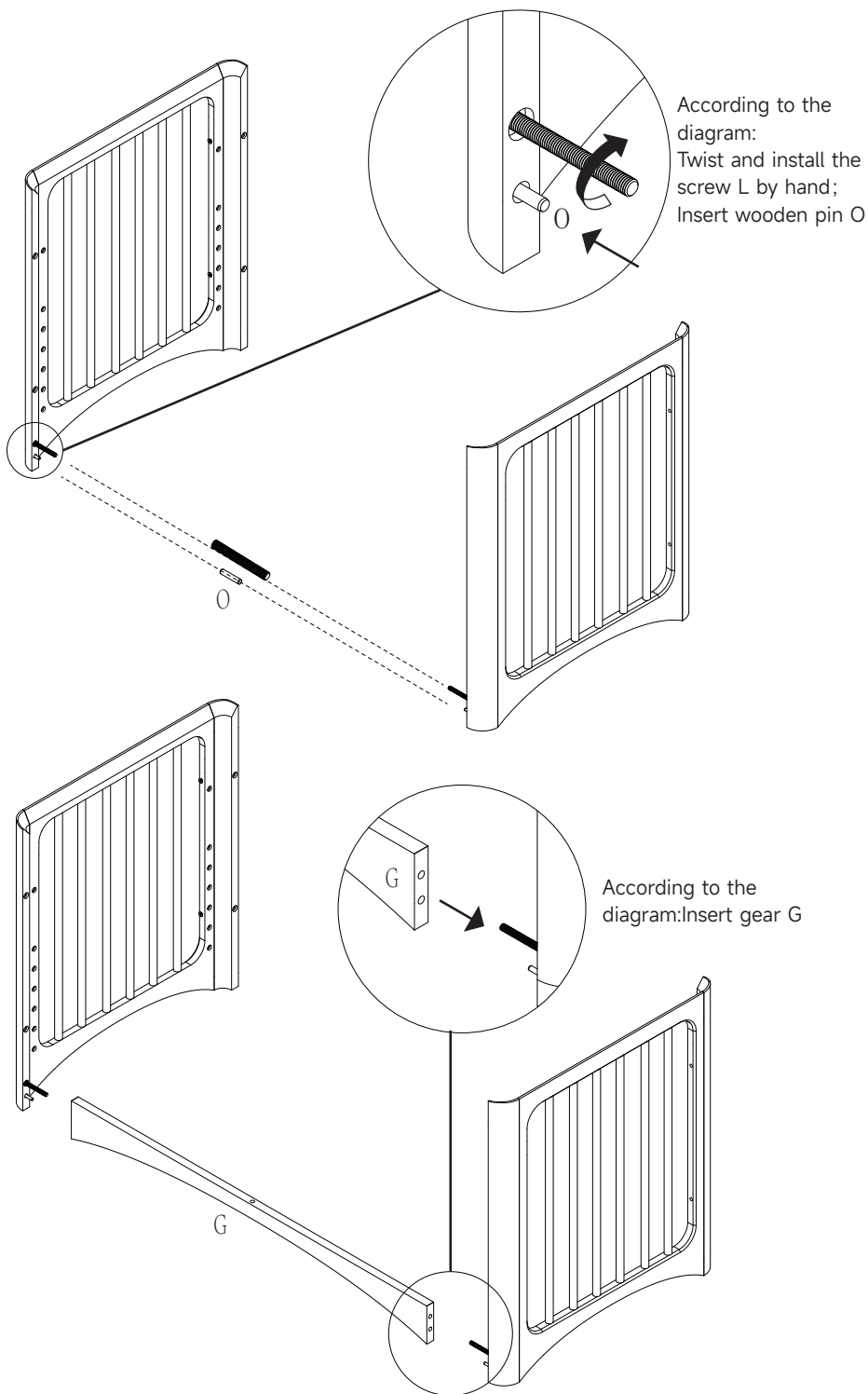



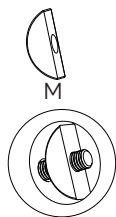
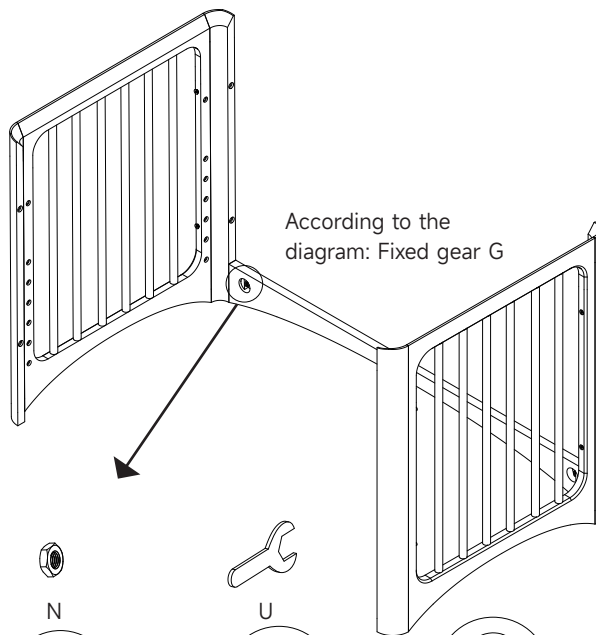

Insert semi-circular stopper M

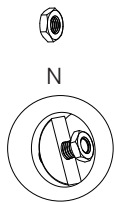

Screw in M8 nut N

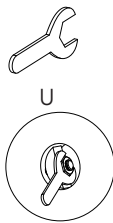

Use an open-end wrench U to tighten the nut N

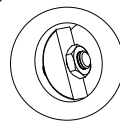

Connection completed

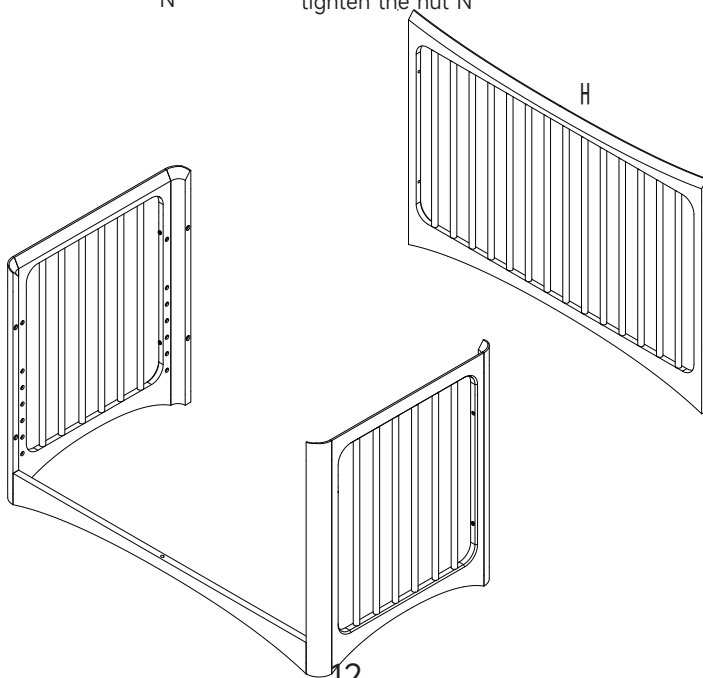

The top of both  
should be aligned  
and leveled

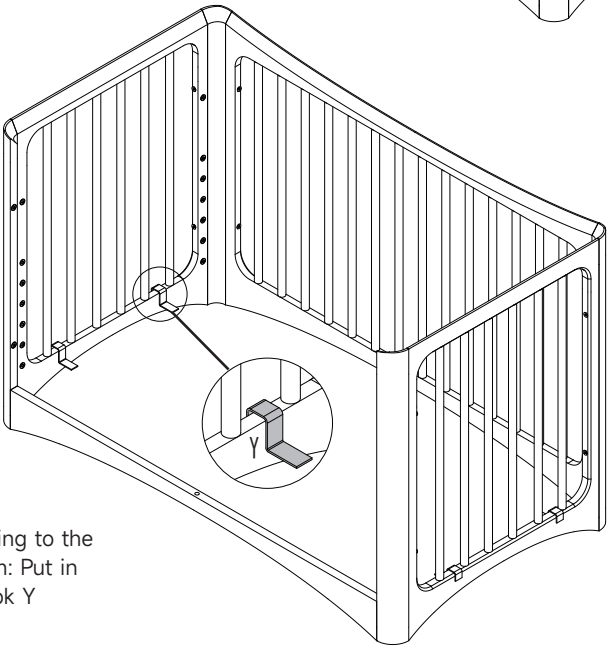
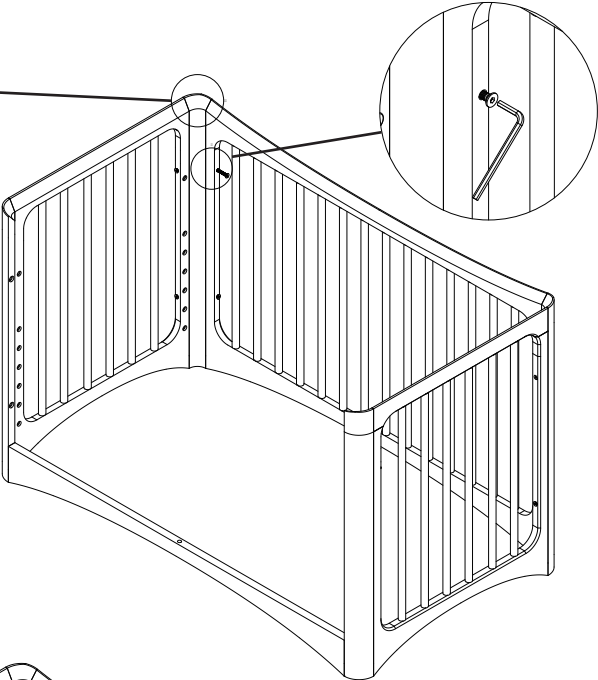
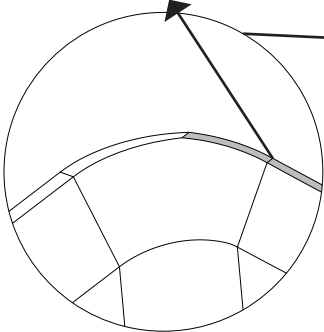

According to the  
diagram: Put in  
the hook Y

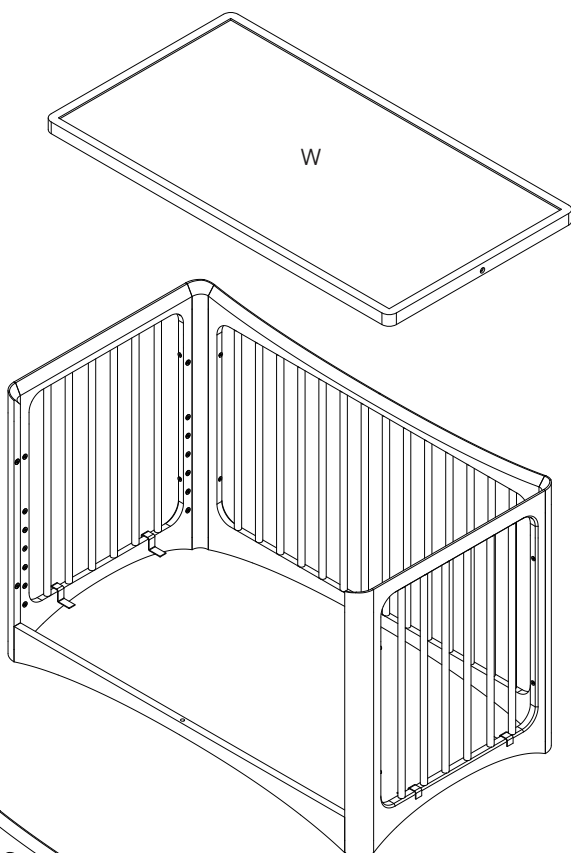

According to the diagram:  
Put into storage board W

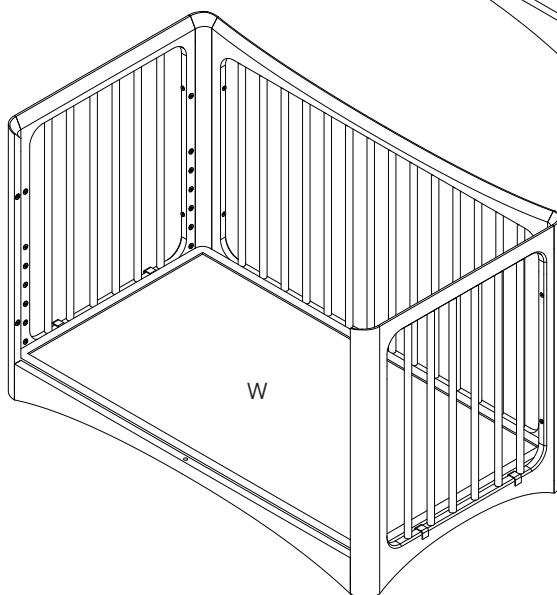

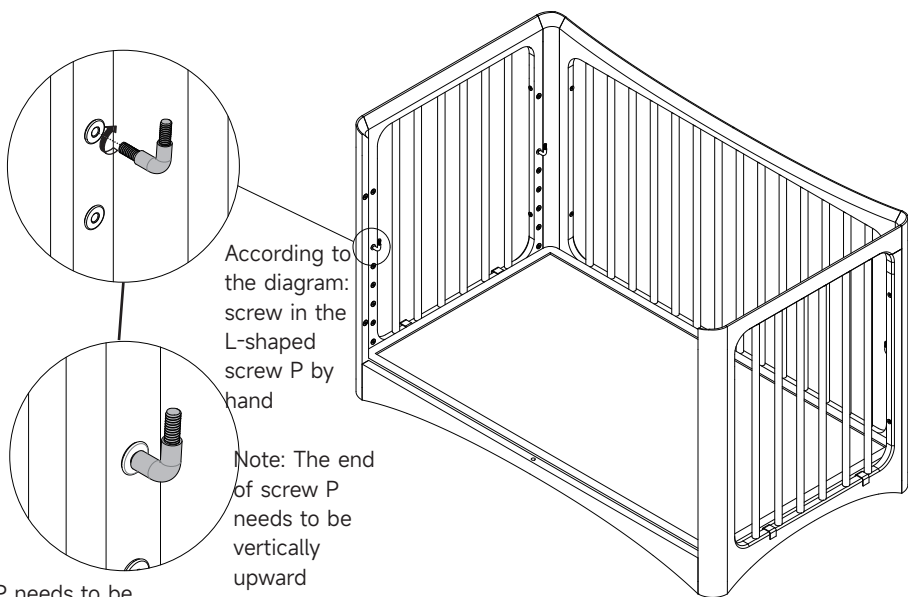

Screw P needs to be from bottom to bottom;  
Pass through this through-hole

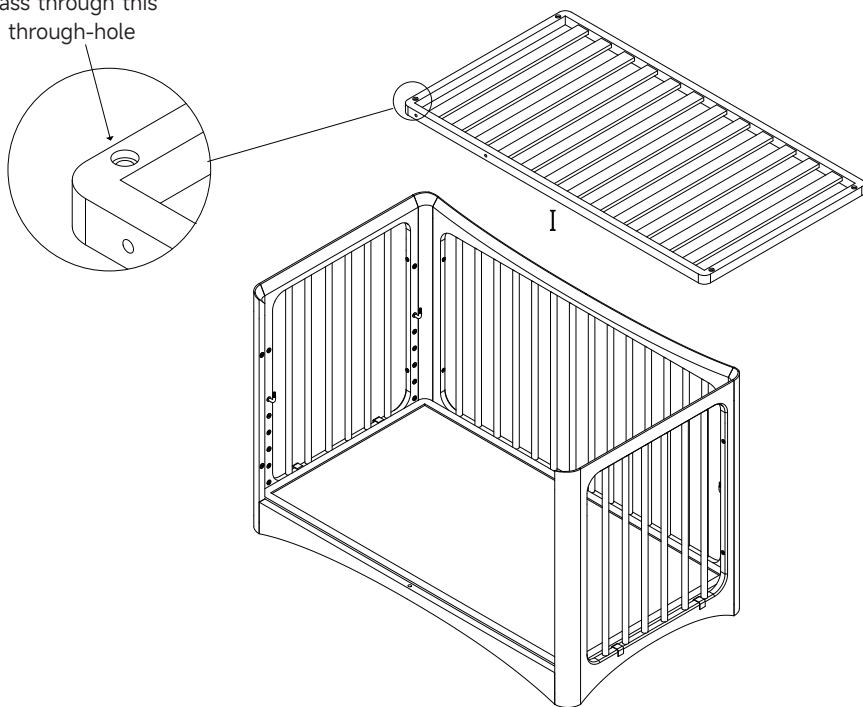

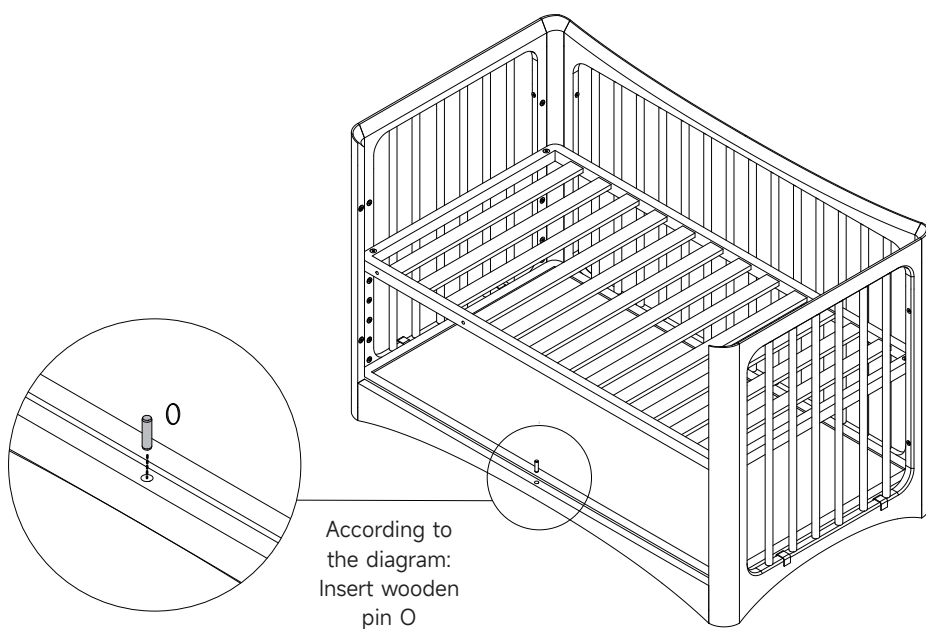
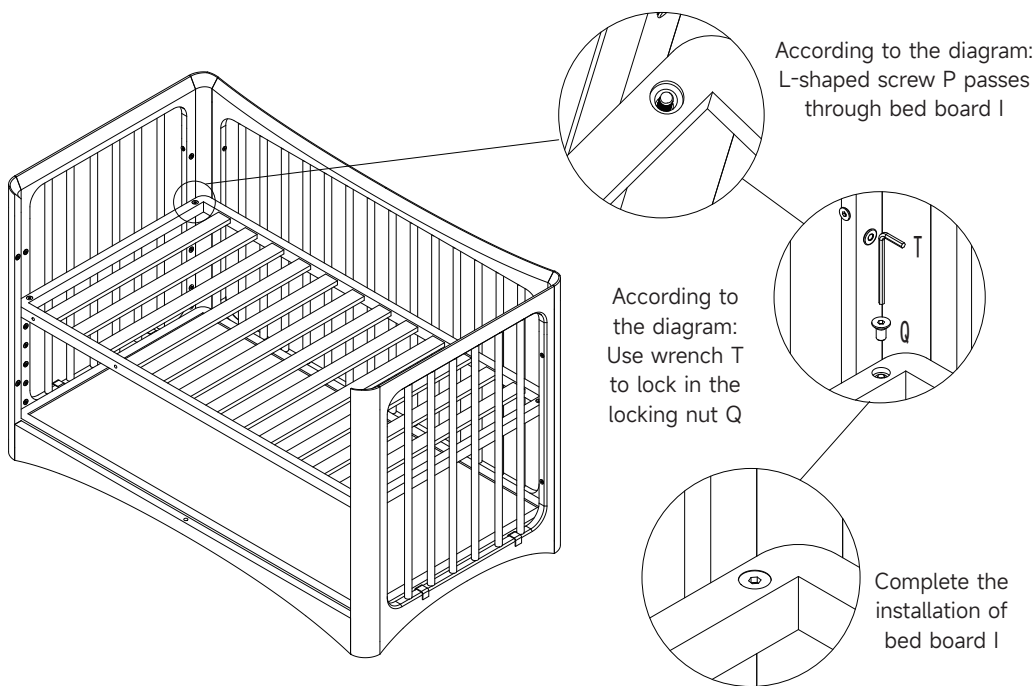

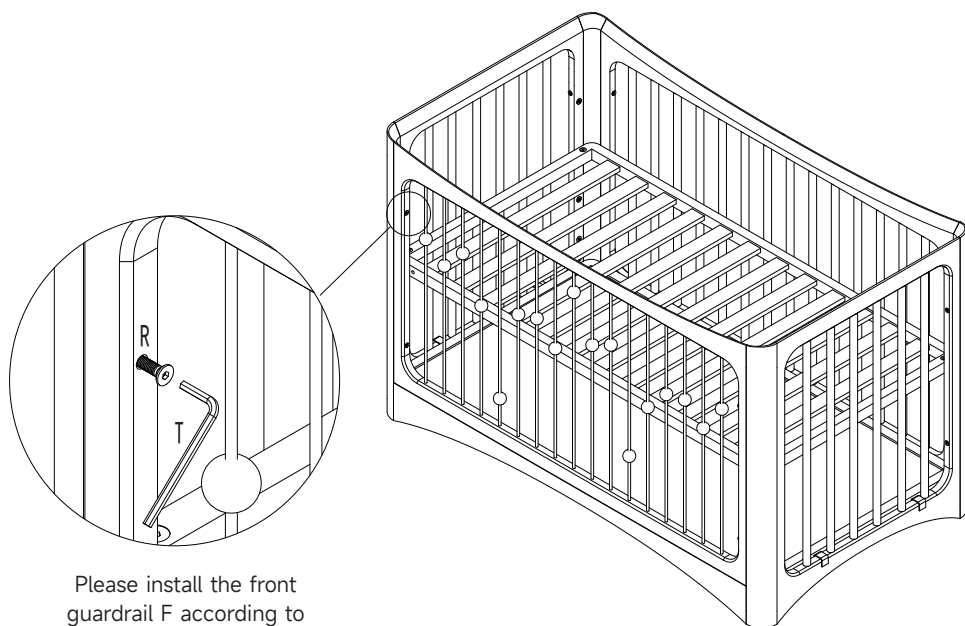
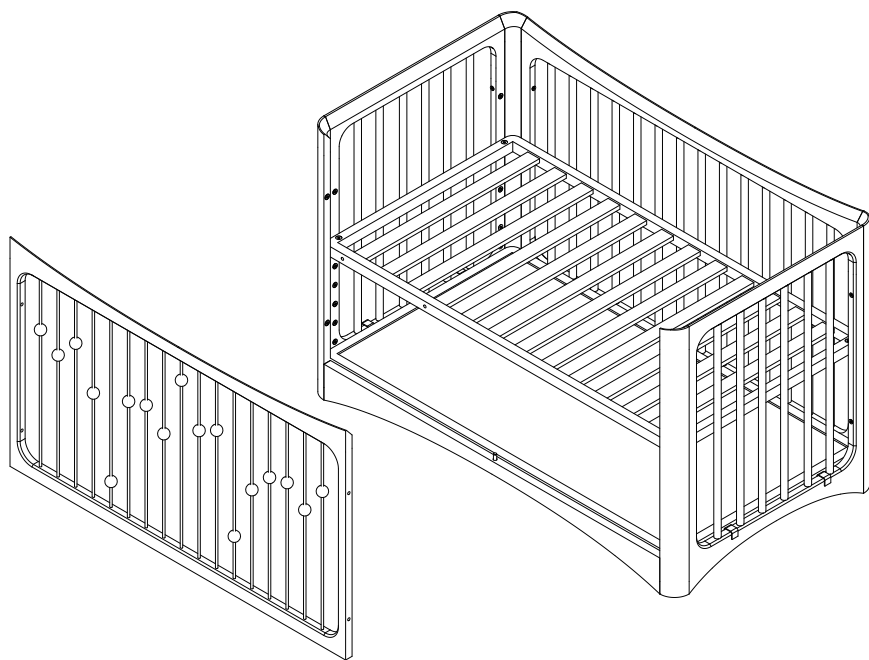

Please install the front  
guardrail F according to  
the diagram



K

According to the  
diagram: Insert the caster

K

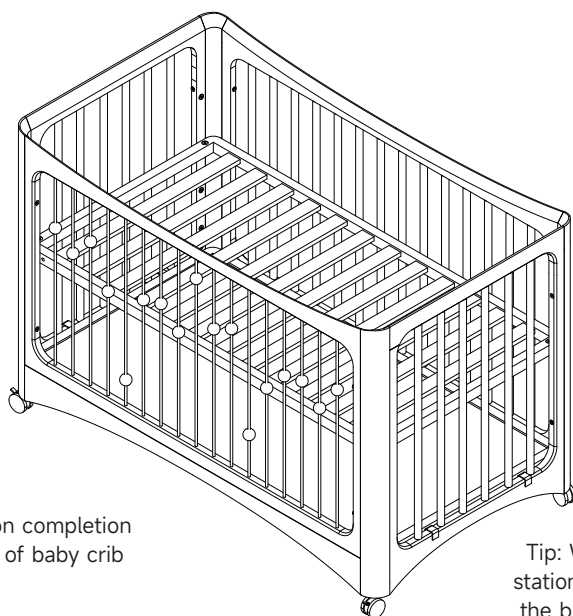

Installation completion  
diagram of baby crib

Tip: When the crib is  
stationary, please press  
the brake pads on the  
casters K!

## Product Function Display

### - Bed Board Height Adjustable in 6 Levels

**Warning: When in crib use, this gear cannot be used for installing bed boards!**

Learning desk installation gear

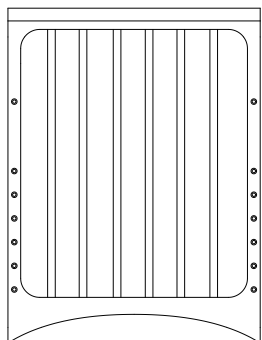

- Baby crib bed board first installation gear
- Baby crib bed board second installation gear
- Baby crib bed board third installation gear
- Baby crib bed board fourth installation gear
- Baby crib bed board fifth installation gear
- Baby crib bed board sixth installation gear

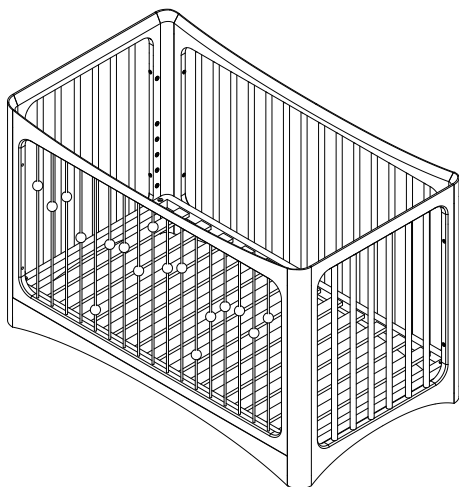
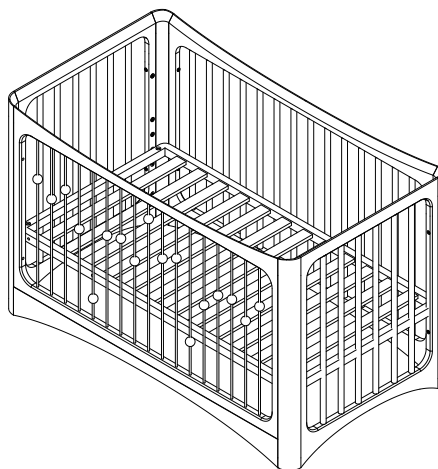

**Warning:**

The crib floor has six adjustable heights, place the bed board of the crib in the lowest position

It is always the safest at all times, when a baby is old enough to sit up or stand up, the bed board of the baby crib must be fixed in the lowest position for use!



## Product Function Display - Children's bed function

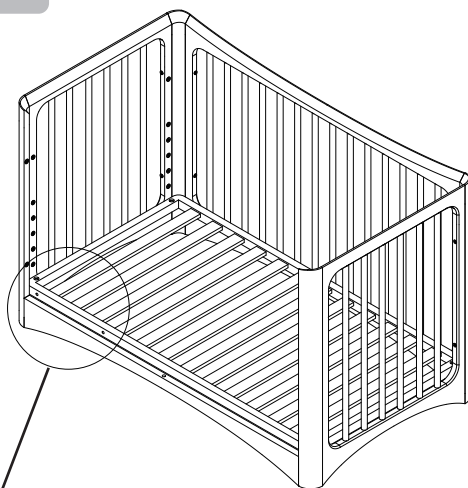
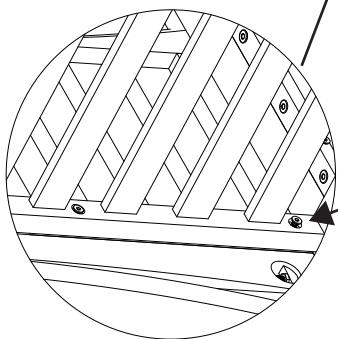
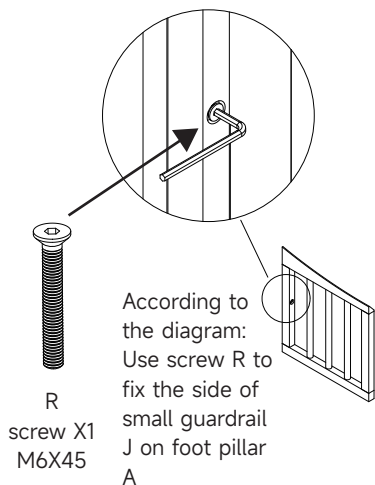

According to the diagram: Use screw S to pass through the edge of bed board I from inside to outside, and fix the small guardrail J on the outside of the bed board.

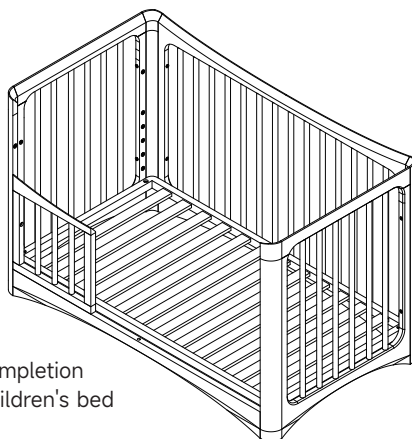

Installation completion  
diagram of children's bed

## Product Function Display - Splicing Function with Adult Bed

Remove the front guardrail F and adjust the height of the bed board I to achieve compatibility with the adult bed the splicing!

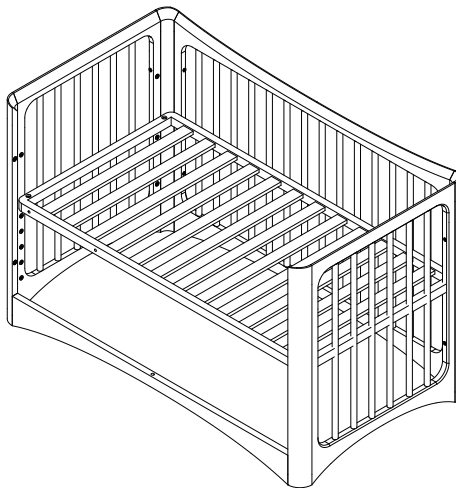

## Product Function Display - Playpen Function

Place the bed board in the lowest position, lay the mattress, and it can be used as a playpen.

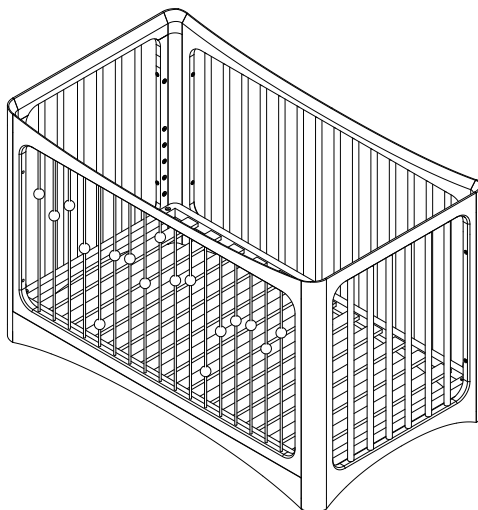

## Product Function Display - Picture Frame Function

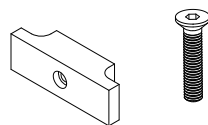

X  
Fixed clamp  
block X2

S  
Screw X2  
M6X35

1

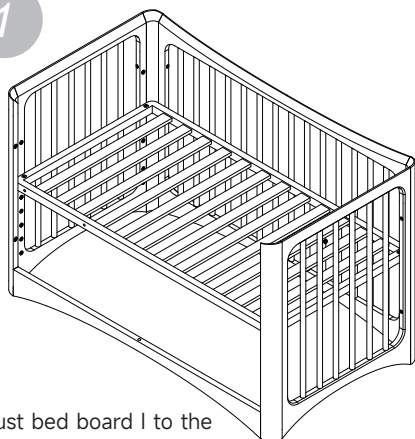

Adjust bed board I to the  
appropriate height

2

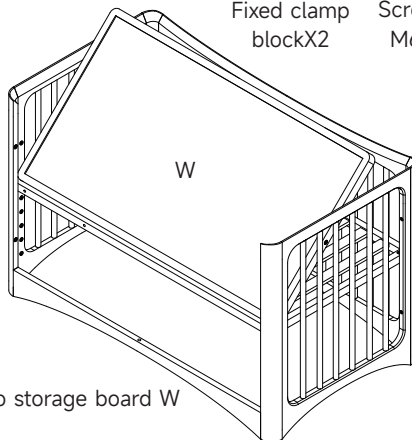

Put into storage board W

3

Adjust the tilt angle  
of storage board W

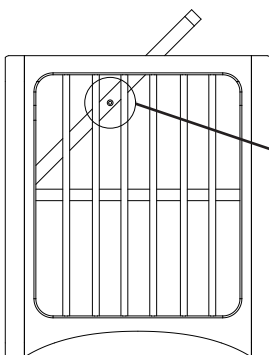

Note: The hole on  
the W side of the  
storage board  
should be located in  
the middle of two  
round bars!

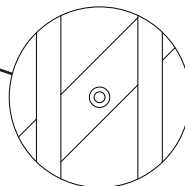

4

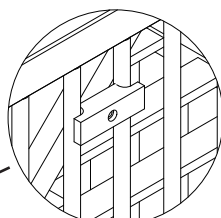

Place the fixed clamp  
block X

5

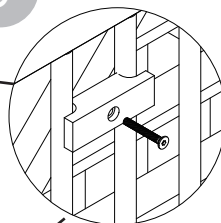

Connect and fix with  
screw S

6

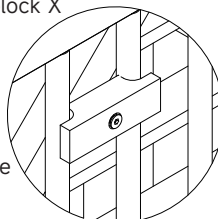

Screw S needs to be  
tightened

Installation completion  
diagram of easel

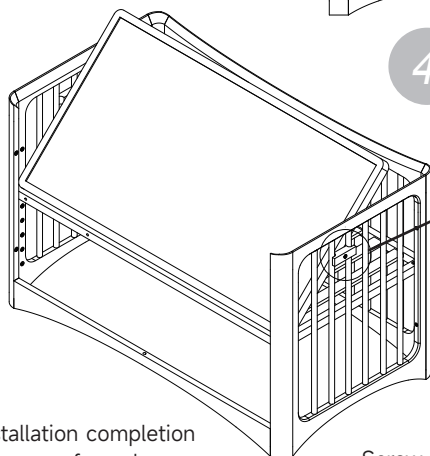

## Product Function Display - Learning Desk Function

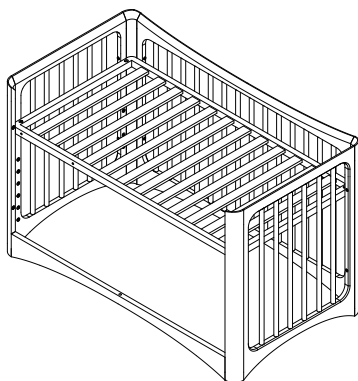

1

Fix bed board I  
onto the  
learning desk  
installation gear

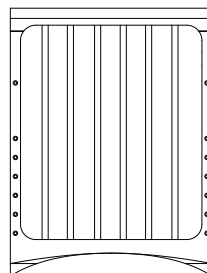

Learning desk  
installation gear

2

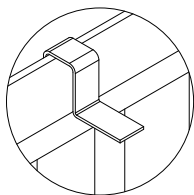

Place hook Y on top  
of the bed head

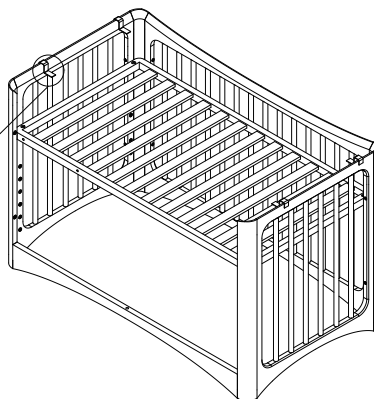

3

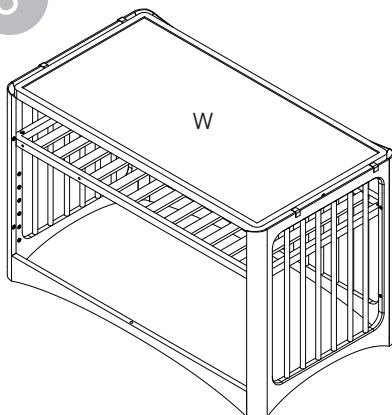

W

Place the storage board W to  
complete the installation of the  
study desk

Operation method for decorative balls  
on the front guardrail before moving

The decorative ball  
on the front guardrail  
can move up and  
down!

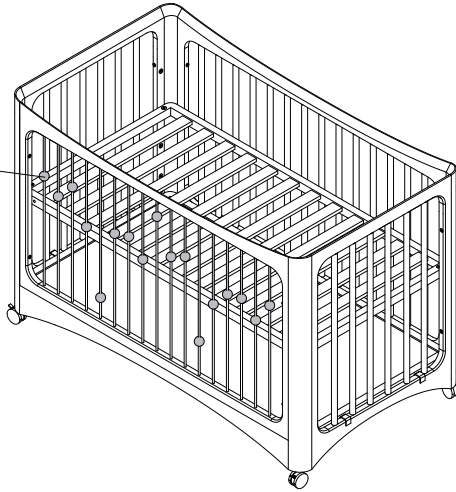

The operation method is shown in the following figure:

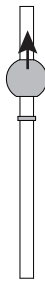

Grasp the decorative  
ball and move it  
upwards to expose  
the rubber band.  
Move the rubber  
band.



Release the  
decorative ball

**CHỖ CHICK**